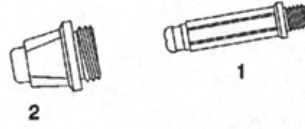
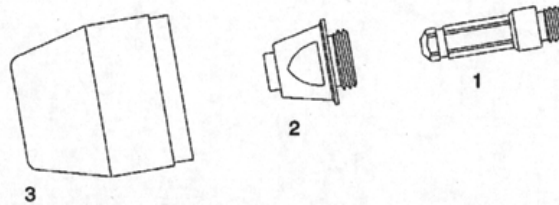
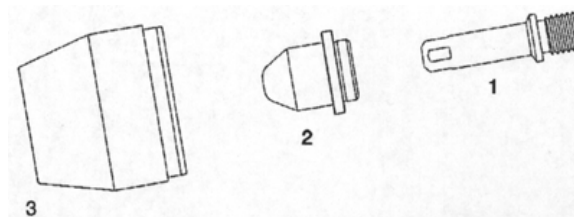

REPLACEMENT PARTS SUITABLE FOR:
MILLER®
APT 3000®

ITEM	CATALOG NUMBER	DESCRIPTION	STD. QTY
1	CS125-069	ELECTRODE	10
2	CS125-070	TIP	10

APT 5000 / 7000®

ITEM	CATALOG NUMBER	DESCRIPTION	STD. QTY
1	CS123-899	ELECTRODE	10
2	CS123-898	TIP 50A	10
	CS134-338	TIP 70A	10
3	CS123-897	SHIELD CUP (APT 5000 ONLY)	5

APT 8000®

ITEM	CATALOG NUMBER	DESCRIPTION	STD. QTY
1	CS125-039	ELECTRODE	10
2	CS125-039/T	ELECTRODE TEFLON COATED	10
3	CS125-038	TIP	10
4	CS125-040	SHIELD CUP	5

Ergodani is in no way affiliated with MILLER®. The parts advertised for sale are not genuine MILLER® parts, but are parts made for and by **Ergodani**. Reference to MILLER® machine, torches and numbers are for your convenience only. We reserve the right to substitute genuine MILLER® parts in place of **Ergodani** parts.

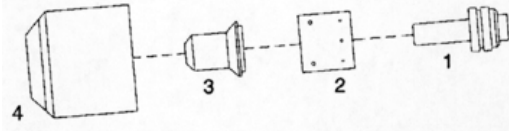
REPLACEMENT PARTS SUITABLE FOR:
MILLER®
ICE 25C® / ICE 27C®

ITEM	CATALOG NUMBER	DESCRIPTION	STD. QTY
1	CS176655	ELECTRODE	10
2	CS176657	SWIRL RING (ICE 25C ONLY)	5
3	CS176656	TIP .030	10
4	CS176658	RETAINING CAP (ICE 25C ONLY)	2

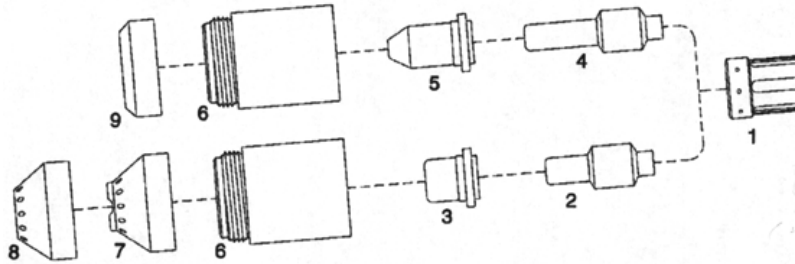
ICE 50C®

ITEM	CATALOG NUMBER	DESCRIPTION	STD. QTY
1	CS177886	SWIRL RING	5
2	CS192047	ELECTRODE (REPLACES CS177875)	10
3	CS177890	TIP	10
4	CS192048	EXTENDED ELECTRODE (REPLACES CS180340)	10
5	CS177876	EXTENDED TIP	10
6	CS177877	RETAINING CAP	1
7	CS192053	SHIELD (DRAG) (REPLACES CS177887)	2
8	CS180341	SHIELD (MACH)	2
9	CS177888	DEFLECTOR	5
N/S	CS51853	CIRCLE CUTTING ATTACHMENT	1
N/S	CS51809	CUTTING GUIDE	1

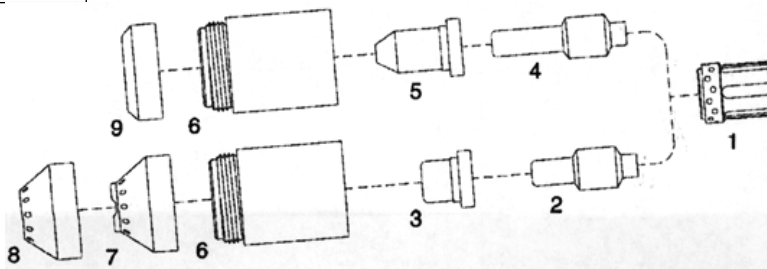
ICE 55C® / ICE 55CM®

ITEM	CATALOG NUMBER	DESCRIPTION	STD. QTY
1	CS192049	SWIRL RING	5
2	CS192047	ELECTRODE (REPLACES CS177875)	10
3	CS192051	TIP STANDARD	10
4	CS192048	EXTENDED ELECTRODE (REPLACES CS180340)	10
5	CS192052	EXTENDED TIP 35A	10
	CS192056	EXTENDED TIP 55A	10
6	CS192050	RETAINING CAP	1
7	CS192053	SHIELD (DRAG) (REPLACES CS177887)	2
8	CS180341	SHIELD (MACH)	2
9	CS177888	DEFLECTOR	5
N/S	CS51853	CIRCLE CUTTING ATTACHMENT	1
N/S	CS51809	CUTTING GUIDE	1

Ergodani is in no way affiliated with MILLER®. The parts advertised for sale are not genuine MILLER® parts, but are parts made for and by Ergodani. Reference to MILLER® machine, torches and numbers are for your convenience only. We reserve the right to substitute genuine MILLER® parts in place of Ergodani parts.

REPLACEMENT PARTS SUITABLE FOR:

MILLER®

ICE 25C® / ICE 27C®

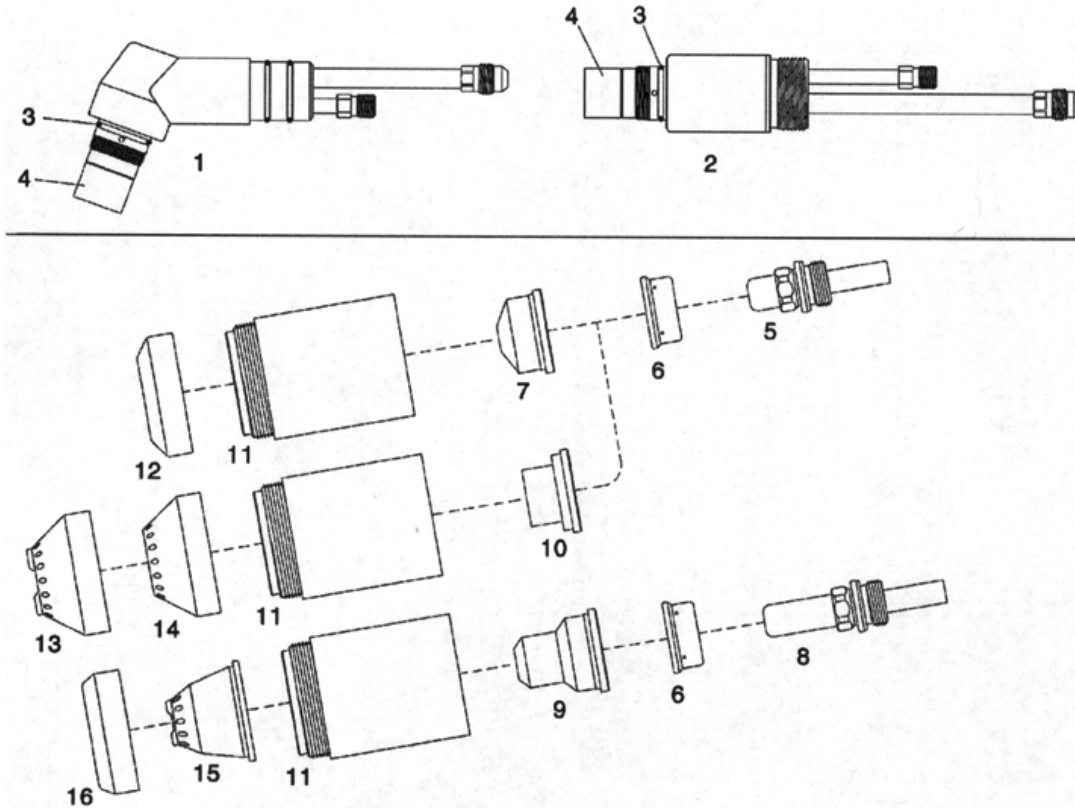

ITEM	CATALOG NUMBER	DESCRIPTION	STD. QTY
1	CS171257	70° TORCH HEAD W/HANDLE	1
N/S	CS07301	HAND SPARE HANDLE COMPLETE WITH MICROSWITCH	1
2	CS171245	180° TORCH HEAD	1
N/S	CS07415	MACHINE SPARE HANDLE	1
3	CS06000.60	O-RING	20
4	CS60090	FRONT INSULATOR	2
5	CS169217	ELECTRODE	10
6	CS169222	SWIRL RING	5
7	CS169220	TIP 80A .052	10
	CS169227	TIP 100A .059	10
8	CS173816	EXTENDED ELECTRODE	10
9	CS173814	EXTENDED TIP 80A .052	10
	CS173815	EXTENDED TIP 100A .059	10
10	CS169219	CONTAC TIP 80A .052	10
	CS169226	CONTAC TIP 100A .059	10
11	CS169223/F	CONTAC SHIELD CAP-FIBER GLASS	1
	CS169223	CONTAC SHIELD CAP-MAX. LIFE	1
12	CS169225	DEFLECTOR	5
13	CS169224	SHIELD CAP (HAND)	2
14	CS169230	SHIELD CAP (MACH)	2
15	CS51980/TD	EXTENDED SHIELD CAP (HAND)	2
16	CS51959/TD	LOCKING NUT	5
N/S	CS60369	EXTRACTOR FOR SWIRL RING	1
N/S	CS51852	CIRCLE CUTTING ATTACHMENT	1
N/S	CS51808	CUTTING GUIDE	1

Ergodani is in no way affiliated with MILLER®. The parts advertised for sale are not genuine MILLER® parts, but are parts made for and by Ergodani. Reference to MILLER® machine, torches and numbers are for your convenience only. We reserve the right to substitute genuine MILLER® parts in place of Ergodani parts.