

REPLACEMENT PARTS SUITABLE FOR:

LINCOLN®

PCT80® / PROCUT 20® / PROCUT 55® / PROCUT 80®

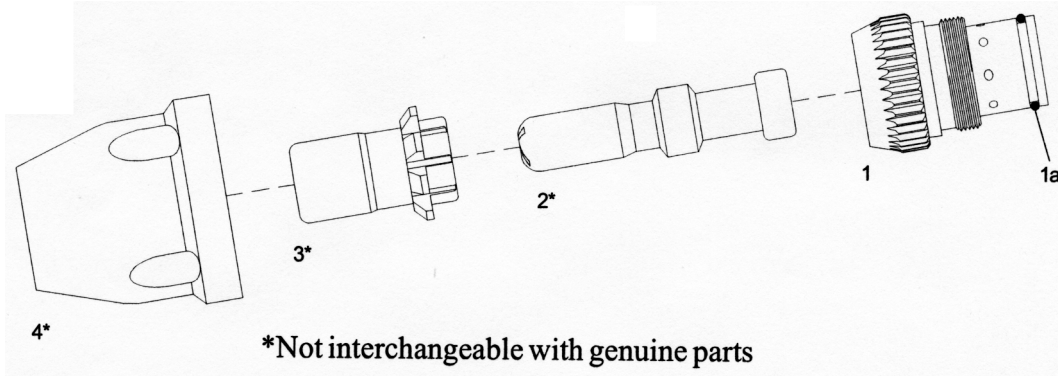

ITEM	CATALOG NUMBER	DESCRIPTION	STD. QTY
1	CSS22148	SWIRL RING ASSEMBLY	1
1a	CST13483-23	O-RING	20
2	CSS22149	ELECTRODE	10
3	CSS22147-028	NOZZLE .028" 0.7 mm 20A	10
	CSS22147-043	NOZZLE .043" 1.5 mm 55A	10
	CSS22147-043	NOZZLE .053" 1.3 mm 80A	10
4	CSS22150	SHIELD	2

T 100®

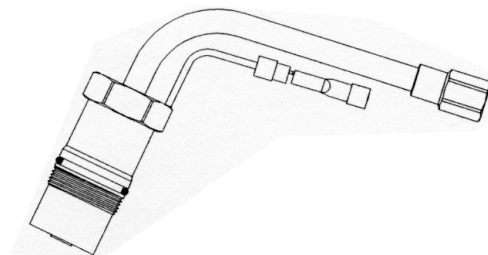

ITEM	CATALOG NUMBER	DESCRIPTION	STD. QTY
1	CS01201/KIT	TORCH HEAD COMPLETE WITH HANDLE	1
2	CS01250LT	HAND TORCH 6 m (20') LEADS-1/8G	1
3	CS01350LT	HAND TORCH 12 m (40') LEADS-1/8G	1
4	CS01251LT	HAND TORCH 6 m (20') LEADS-EUROCONECTOR	1
5	CS01351LT	HAND TORCH 12 m (40') LEADS-EUROCONECTOR	1

Ergodani is in no way affiliated with LINCOLN®. The parts advertised for sale are not genuine LINCOLN® parts, but are parts made for and by Ergodani. Reference to LINCOLN® machine, torches and numbers are for your convenience only. We reserve the right to substitute genuine LINCOLN® parts in place of Ergodani parts.