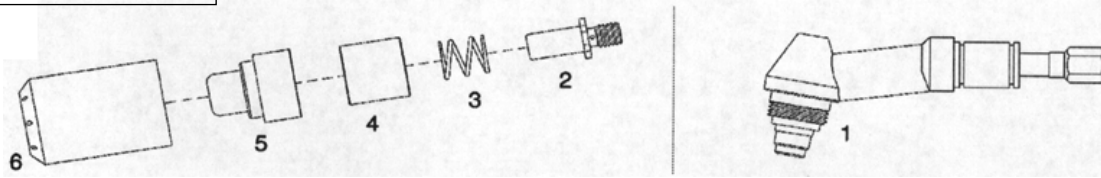
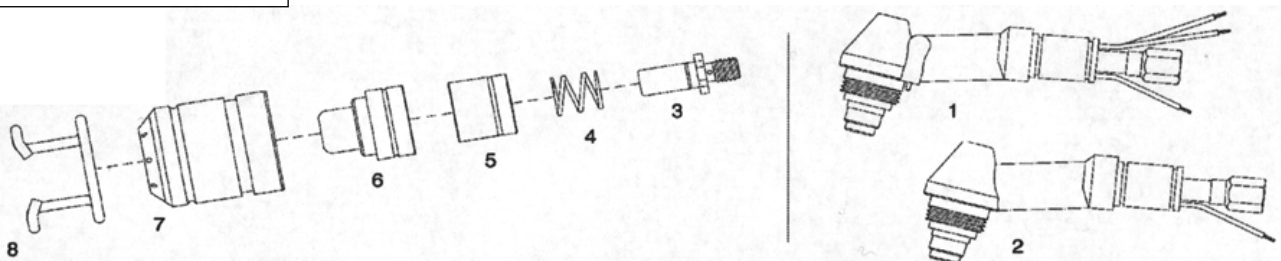
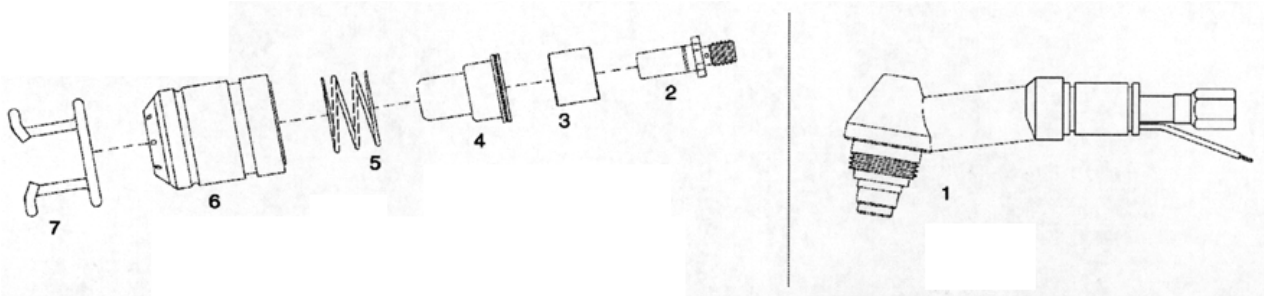

**REPLACEMENT PARTS SUITABLE FOR:**
**BINZEL®**
**PSB 30®**

ITEM	CATALOG NUMBER	DESCRIPTION	STD. QTY
N/S	CS744.0114	TORCH COMPLETE WITH 4 m CABLE (3/8" CONNECTION)	1
N/S	CS744.0115	TORCH COMPLETE WITH 6 m CABLE (3/8" CONNECTION)	1
1	CS744.0098	70° TORCH HEAD	1
N/S	CS744.0044	HANDGRIP COMPLETE WITH MICROSWITCH	1
2	CS744.0014	ELECTRODE 14.5 mm	10
	CS744.0013	ELECTRODE 15 mm	10
	CS744.0012	ELECTRODE 15.5 mm	10
3	CS744.0024	SPRING	10
4	CS744.0076	INSULATING SLEEVE-HF VERSION	5
	CS744.0023	SPRING SLEEVE	5
5	CS744.0010	TIP 1.0	10
	CS744.0061	TIP 1.2	10
6	CS744.0011	AIR DIFFUSOR INSULATOR	2
N/S	CS07784	AIR AND POWER CABLE 4 m (3/8" CONNECTION)	1
N/S	CS07786	AIR AND POWER CABLE 6 m (3/8" CONNECTION)	1
N/S	CS51854	CIRCLE CUTTING ATTACHMENT	1
N/S	CS51810	CUTTING GUIDE	1

**REPLACEMENT PARTS SUITABLE FOR:**
**PSB 31®**

ITEM	CATALOG NUMBER	DESCRIPTION	STD. QTY
N/S	CS742.0046	TORCH COMPLETE WITH 4 m CABLE (1/4" CONNECTION)	1
N/S	CS742.0087	TORCH COMPLETE WITH 6 m CABLE (1/4" CONNECTION)	1
N/S	CS742.0047	TORCH HF S COMPLETE WITH 4 m CABLE (1/4" CONNECTION)	1
N/S	CS742.0088	TORCH HF S COMPLETE WITH 6 m CABLE (1/4" CONNECTION)	1
1	CS442P010100TB	70° TORCH BODY WITH SAFETY	1
N/S	CS742.0044	HANDGRIP COMPLETE WITH MICROSWITCH	1
2	CS742.0054	70° TORCH HEAD	1
3	CS742.0016	ELECTRODE 15.5 mm	10
	CS742.0017	ELECTRODE 16 mm	10
	CS742.0018	ELECTRODE 16.5 mm	10
4	CS744.0024	SPRING	10
5	CS742.0038	INSULATING SLEEVE-HF VERSION	5
	CS742.0025	SPRING SLEEVE	5
6	CS742.0011	TIP 1.0	10
	CS742.0026	TIP 1.2	10
7	CS742.0004	AIR DIFFUSOR INSULATOR	2
N/S	CS442P010101TB	AIR DIFFUSOR INSULATOR WITH SAFETY	2
8	CS742.0089	SPACER SPRING	10
N/S	CS07774	AIR AND POWER CABLE 4 m (1/4" CONNECTION)	4
N/S	CS07776	AIR AND POWER CABLE 6 m (1/4" CONNECTION)	4
N/S	CS51855	CIRCLE CUTTING ATTACHMENT	4
N/S	CS51811	CUTTING GUIDE	4

**REPLACEMENT PARTS SUITABLE FOR:**
**BINZEL®**
**PSB 31KK®**

ITEM	CATALOG NUMBER	DESCRIPTION	STD. QTY
N/S	CS744.0114	TORCH COMPLETE WITH 4 m CABLE (3/8" CONNECTION)	1
N/S	CS744.0115	TORCH COMPLETE WITH 6 m CABLE (3/8" CONNECTION)	1
1	CS744.0098	70° TORCH HEAD	1
N/S	CS744.0044	HANDGRIP COMPLETE WITH MICROSWITCH	1
2	CS744.0014	ELECTRODE 14.5 mm	10
	CS744.0013	ELECTRODE 15 mm	10
	CS744.0012	ELECTRODE 15.5 mm	10
3	CS744.0024	SPRING	5
4	CS744.0076	INSULATING SLEEVE-HF VERSION	10
	CS744.0023	SPRING SLEEVE	10
5	CS744.0010	TIP 1.0	10
	CS744.0061	TIP 1.2	2
6	CS744.0011	AIR DIFFUSOR INSULATOR	10
N/S	CS07784	AIR AND POWER CABLE 4 m (3/8" CONNECTION)	1
N/S	CS07786	AIR AND POWER CABLE 6 m (3/8" CONNECTION)	1
N/S	CS51854	CIRCLE CUTTING ATTACHMENT	1
N/S	CS51810	CUTTING GUIDE	1

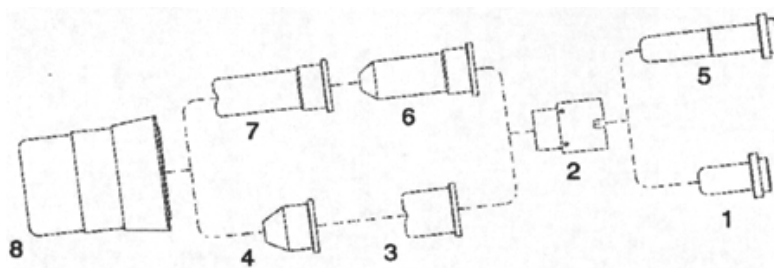
**REPLACEMENT PARTS SUITABLE FOR:**
**CEBORA®**
**P 30®**
**art. 920, art. 925, art. 936**

ITEM	CATALOG NUMBER	DESCRIPTION	STD. QTY
1	CS1520	ELECTRODE	10
2	CS1510	SWIRL RING	5
3	CS1304	TIP (CASTEL)	10
4	CS1305	TIP (PIPE)	10
5	CS1519	EXTENDED ELECTRODE	10
6	CS1306	EXTENDED TIP (PIPE)	10
7	CS1370	EXTENDED TIP (CASTEL)	10
8	CS5.710.120	RETAINING CAP	2